

CREativity makes VISion of the future



CREVIS

PRODUCTS

- S-Series
- A-Series
- C-Series
- B-Series
- I/O guide PRO
- Wiring Diagram

Catalogue

www.crevis.co.kr

Edition : 2016-rev.01

FnIO Features

FnIO S-Series is the Network IO of the slice type for FieldBus system, like DeviceNet, PROFIBUS, PROFINET, CANopen, CC-Link, and etc, which applied FES design technique. FnIO S-Series was designed for the user's convenience and RTB(Removable Terminal Block) applied the small size for easy wiring and easy fixing. FnIO S-Series has the header type module which can 16 points as well, so that user can use many points and easy wiring.

FnIO considered the economic efficiency for this design, wiring cost, module change, maintenance and etc to save the material cost. In addition, for the safe system configuration, it uses the pin slide type and this type makes the contact maximum between modules. Each I/O modules also adapt the U-Processor for the strong diagnostic function.

1) Screwless Connection System

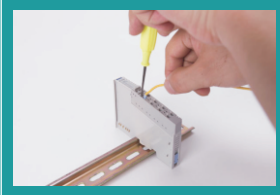

Applying the push type for easy wiring. Connecting or removing the cable by pushing the terminal button for the relevant points.

2) The hole for Test Pin

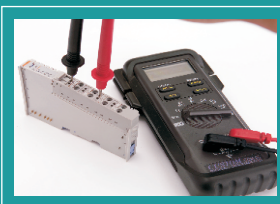

After wiring, checking the input or output value.

3) Switch for the address.

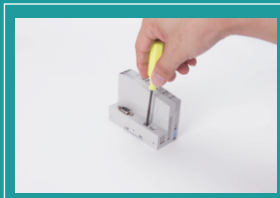

Rotary Switch for setting up the address.

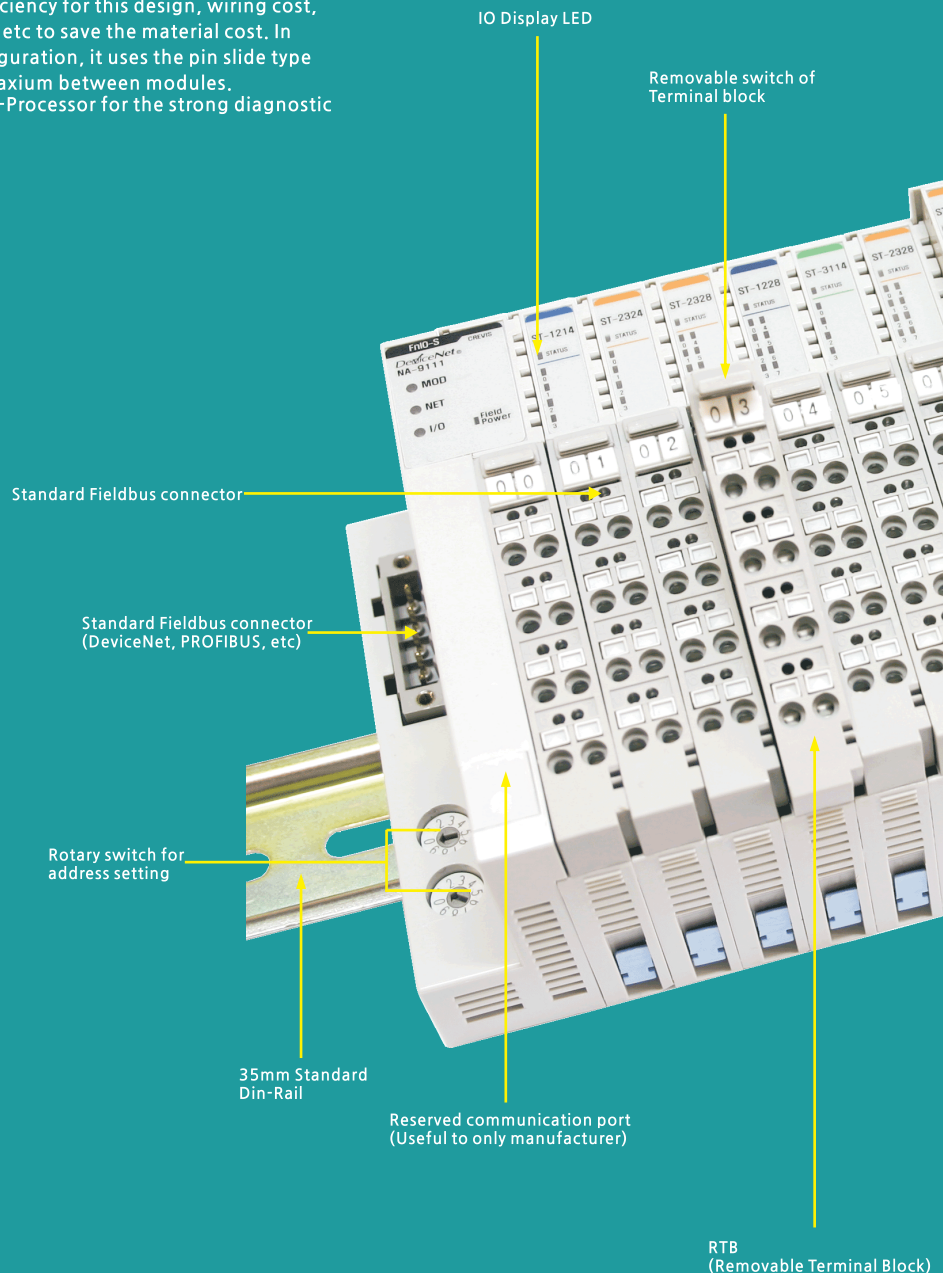

RTB (Removable Terminal Block)

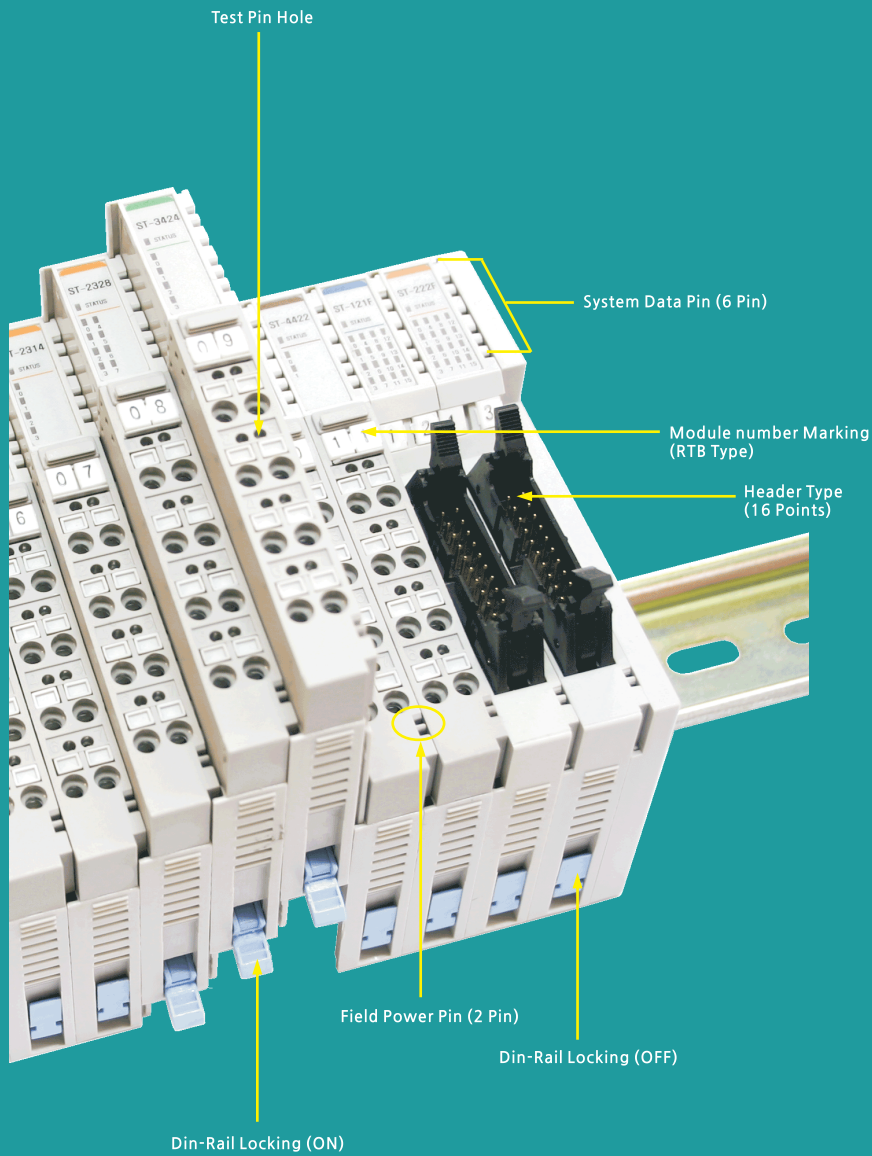

4, 5) Din Rail Locking Switch

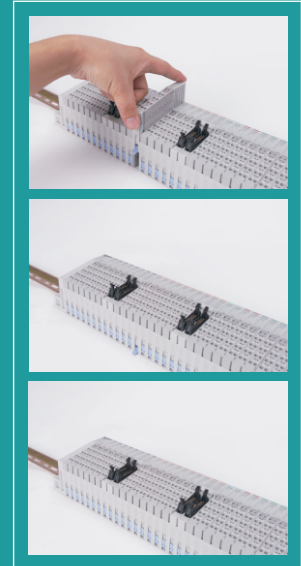

Easy combination and easy removal for IO modules on the din rail through One Touch Locking Switch.

6) Field Power & System Power



Safety from the vibration and shock due to the pin sliding type.

7) RTB (Removable Terminal Block)

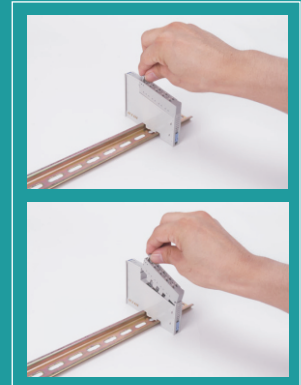

There is a locking switch on the RTB for the easy combination and easy removal.

8) RTB (Removable Terminal Block)

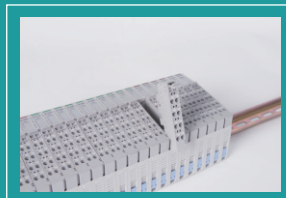

Whole terminal block can be combined and removed for the convenience of its maintenance.

INDEX

FnIO-S series

Network Adapter

1-3	NA-9111	DeviceNet Network Adapter, 32 bytes input and 32 bytes output
1-3	NA-9112	Premium DeviceNet Network Adapter, 252 bytes input and 252 bytes output
1-6	NA-9122	PROFIBUS DP/V1 Network Adapter, 128 bytes input and 128 bytes output
1-11	NA-9131	CC-Link Network Adapter, RX/RX 112 points and RWr/RWw 16 points
1-15	NA-9161	CANopen Network Adapter, 64 bytes input and 64 bytes output
1-19	NA-9171	MODBUS RS232 Network Adapter, 252 bytes input and 252 bytes output
1-19	NA-9173	MODBUS RS485 Network Adapter, 252 bytes input and 252 bytes output
1-23	NA-9187	PROFINET I/O RT Protocol Adapter, 128 bytes input and 128 bytes output
1-27	NA-9188	EtherNet/IP Network Adapter, 252 bytes input and 252 bytes output
1-31	NA-9189	MODBUS TCP/IP Network Adapter, 252 bytes input and 252 bytes output

Network Adapter (NEW Platform)

1-33	NA-9211	DeviceNet Network Adapter, 32 bytes input and 32 bytes output
1-33	NA-9212	Premium DeviceNet Network Adapter, 252 bytes input and 252 bytes output
1-37	NA-9222	PROFIBUS DP/V1 Network Adapter, 244 bytes input and 244 bytes output
1-41	NA-9261	CANopen Network Adapter, 252 bytes input and 252 bytes output
1-45	NA-9285	CC-Link IE Network Adapter, 252 bytes input and 252 bytes output
1-49	NA-9286	EtherCAT Network Adapter, 252 bytes input and 252 bytes output
1-53	NA-9386	EtherCAT ID Network Adapter, 252 bytes input and 252 bytes output
1-57	NA-9287	PROFINET I/O RT Protocol Adapter, 252 bytes input and 252 bytes output
1-61	NA-9288	EtherNet/IP Network Adapter, 252 bytes input and 252 bytes output
1-65	NA-9289	MODBUS TCP/IP Network Adapter, 252 bytes input and 252 bytes output
1-67	NA-9371	MODBUS Programmable I/O
1-71	NA-9372	MODBUS Programmable I/O
1-75	NA-9373	MODBUS Programmable I/O

Digital Input

1-79	ST-1114	Digital Input 4 Points, Sink, Terminal, 5Vdc
1-79	ST-111F	Digital Input 16 Points, Sink, 20P Connector 5Vdc
1-80	ST-1124	Digital Input 4 Points, Source, Terminal, 5Vdc
1-80	ST-112F	Digital Input 16 Points, Source, 20P Connector 5Vdc
1-81	ST-1214	Digital Input 4 Points, Sink, Terminal, 12V / 24Vdc
1-81	ST-1218	Digital Input 8 Points, Sink, Terminal, 12V / 24Vdc
1-82	ST-121F	Digital Input 16 Points, Sink, 20P Connector, 12V/24Vdc
1-83	ST-1224	Digital Input 4 Points, Source, Terminal, 12V / 24Vdc
1-83	ST-1228	Digital Input 8 Points, Source, Terminal, 12V / 24Vdc
1-84	ST-122F	Digital Input 16 Points, Source, 20P Connector, 12V/24Vdc
1-85	ST-1314	Digital Input 4 Points, Sink, Terminal, 48Vdc
1-85	ST-131F	Digital Input 16 Points, Sink, 20P Connector 48Vdc
1-86	ST-1324	Digital Input 4 Points, Source, Terminal, 48Vdc
1-86	ST-132F	Digital Input 16 Points, Source, 20P Connector 48Vdc
1-87	ST-1804	Digital Input 4 Points, 120Vac (AC 85V ~ 132V)
1-87	ST-1904	Digital Input 4 Points, 240Vac (AC 170V ~ 264V)

Digital Output

1-89	ST-2114	Digital Output 4 Points, TTL Inverting, Terminal, 5Vdc / 20mA
1-89	ST-2124	Digital Output 4 Points, TTL Non-Inverting, Terminal, 5Vdc / 20mA
1-90	ST-221F	Digital Output 16 Points, Sink, 20P Connector, 24Vdc / 0.5A
1-90	ST-222F	Digital Output 16 Points, Source, 20P Connector, 24Vdc / 0.5A
1-91	ST-2314	Digital Output 4 Points, Sink, Terminal, 24Vdc / 0.5A
1-91	ST-2318	Digital Output 8 Points, Sink, Terminal, 24Vdc / 0.5A
1-92	ST-2414	Digital Output 4 Points, Sink, Terminal, Diagnostics, 24Vdc / 0.5A
1-93	ST-2324	Digital Output 4 Points, Source, Terminal, 24Vdc / 0.5A
1-93	ST-2328	Digital Output 8 Points, Source, Terminal, 24Vdc / 0.5A
1-94	ST-2424	Digital Output 4 Points, Source, Terminal, Diagnostics, 24Vdc / 0.5A
1-95	ST-2514	Digital Output 4 Points, Sink, Terminal, Diagnostics, 24Vdc / 2A

1-95	ST-2614	Digital Output 4 Points, Sink, Terminal, 24Vdc / 2A
1-96	ST-2524	Digital Output 4 Points, Source, Terminal, Diagnostics, 24Vdc / 2A
1-96	ST-2624	Digital Output 4 Points, Source, Terminal, 24Vdc / 2A
1-97	ST-2742	Relay Output 2 Points, Terminal, 230Vac / 2A, 24Vdc/2A
1-97	ST-2744	Relay Output 4 Points, Terminal, 230Vac / 2A, 24Vdc/2A
1-98	ST-2748	Relay Output 8 Points, Terminal, 230Vac / 2A, 24Vdc/2A
1-98	ST-2792	Relay Output 2 Points, Terminal, 230Vac / 2A, Manual Type
1-99	ST-2852	Triac Output 2 Points, 12V ~ 125Vac / 0.5A
1-100	ST-2734	4 Points, 24Vac/2A, 24Vdc/2A, 4 Points/4COM
1-100	ST-2944	4 Points, 24~220Vac/0.5A, 24~220Vdc/0.5A, 1 Points/1COM
1-101	ST-2924	4 Points, 24Vac/2A, 24Vdc/2A, 4 Points/4COM

Analog Input

1-105	ST-3114	Analog Input 4 Channels, 0~20mA, 12Bit, status
1-105	ST-3118	Analog Input 8 Channels, 0~20mA, 12Bit, status
1-106	ST-3134	Analog Input 4 Channels, 0~20mA, 14Bit, status
1-107	ST-3214	Analog Input 4 Channels, 4~20mA, 12Bit, status
1-107	ST-3218	Analog Input 8 Channels, 4~20mA, 12Bit, status
1-108	ST-3234	Analog Input 4 Channels, 4~20mA, 14Bit, status
1-109	ST-3424	Analog Input 4 Channels, 0~10Vdc, 12Bit, status
1-109	ST-3428	Analog Input 8 Channels, 0~10Vdc, 12Bit, status
1-110	ST-3444	Analog Input 4 Channels, 0~10Vdc, 14Bit, status
1-111	ST-3274	Analog Input 4 Channels, Sensor Connector Type, 4~20mA, 12Bit, status
1-111	ST-3474	Analog Input 4 Channels, Sensor Connector Type, 0~10Vdc, 12Bit, status
1-112	ST-3524	Analog Input 4 Channels, -10~+10Vdc, 12Bit, status
1-112	ST-3544	Analog Input 4 Channels, -10~+10Vdc, 14Bit, status
1-113	ST-3624	Analog Input 4 Channels, 0~5Vdc, 12Bit, status
1-113	ST-3644	Analog Input 4 Channels, 0~5Vdc, 14Bit, status
1-114	ST-3702	Analog Input 2 Channels, RTD, status
1-115	ST-3704	Analog Input 4 Channels, RTD, status
1-115	ST-3708	Analog Input 8 Channels, RTD, status
1-116	ST-3714	Analog Input 4 Channels, TEMP. Controller, RTD Input, SSR Output
1-116	ST-3734	Analog Input 4 Channels, TEMP. Controller, RTD Input, Current Output
1-117	ST-3802	Analog Input 2 Channels, Thermocouple
1-118	ST-3804	Analog Input 4 Channels, Thermocouple
1-118	ST-3808	Analog Input 8 Channels, Thermocouple
1-119	ST-3814	Analog Input 4 Channels, TEMP. Controller, TC Input, SSR Output
1-119	ST-3834	Analog Input 4 Channels, TEMP. Controller, TC Input, Current Output

Analog Output

1-131	ST-4112	Analog Output 2 Channels, 0~20mA, 12Bit
1-131	ST-4114	Analog Output 4 Channels, 0~20mA, 12Bit
1-132	ST-4212	Analog Output 2 Channels, 4~20mA, 12Bit
1-132	ST-4214	Analog Output 4 Channels, 4~20mA, 12Bit
1-133	ST-4422	Analog Output 2 Channels, 0~10V, 12Bit
1-133	ST-4424	Analog Output 4 Channels, 0~10V, 12Bit
1-134	ST-4491	Analog Output 1 Channel, 0~10V, 12Bit, Manual Type
1-135	ST-4274	Analog Output 4 Channels, Sensor Connector Type, 4~20mA, 12Bit
1-135	ST-4474	Analog Output 4 Channels, Sensor Connector Type, 0~10V, 12Bit
1-136	ST-4522	Analog Output 2 Channels, -10~+10V, 12Bit
1-137	ST-4622	Analog Output 2 Channels, 0~5V, 12Bit
1-138	ST-4911	Analog Output 1 Channel, 0~1A, 12Bit

Special Module

1-145	ST-5101/5111	High Speed Counter, 1 Channel, 5Vdc/24Vdc
1-147	ST-5112	2 channels High Speed Counter Input, 24Vdc
1-147	ST-5114	4 channels High Speed Counter Input, 24Vdc
1-149	ST-5211	Serial Interface RS232 1 Channel

1-149	ST-5212	Serial Interface RS232 2 Channels
1-150	ST-5221	Serial Interface RS422 1 Channel
1-151	ST-5231	Serial Interface RS485 1 Channel
1-151	ST-5232	Serial Interface RS485 2 Channels
1-152	ST-5252	Serial Module RS232 Communication 2 Channels, Premium type
1-152	ST-5272	Serial Module RS485 Communication 2 Channels, Premium type
1-154	ST-5351	1 channel SSI Interface
1-155	ST-5422	2 channels PWM Output, 1.5A/24Vdc, Source
1-155	ST-5442	2 channels PWM Output, 0.5A/24Vdc, Source
1-156	ST-5444	4 channels PWM Output, 0.5A/24Vdc, Source
1-157	ST-5641	1 channel Pulse Output, 0.5A/24Vdc, Source
1-157	ST-5642	2 channels Pulse Output, 0.5A/24Vdc, Source
1-158	ST-5651	1 channel Pulse Output, RS422
1-159	ST-5725	Extension Function IO, Master
1-159	ST-5726	Extension Function IO, Slave

Power Module

1-177	ST-7008	Shield Module
1-177	ST-7408	Shield Module, ID Type
1-179	ST-7108	Common for 0Vdc
1-179	ST-7508	Common for 0Vdc, ID Type
1-181	ST-7111	Expansion power Supply, Input 24Vdc / Output 1.0A/5Vdc
1-181	ST-7511	Expansion Power Supply, Input 24Vdc, Output 1.0A/5Vdc, ID Type
1-183	ST-7118	Common for 24Vdc
1-183	ST-7518	Common for 24Vdc, ID Type
1-185	ST-7188	Common for 5Vdc and 0Vdc
1-186	ST-7191	Field Distributor, 24Vdc
1-187	ST-7241	Field Distributor, Arbitrary 5Vdc, 24Vdc, 48Vdc, 110Vac, 220Vac
1-187	ST-7641	Field Distributor, 5Vdc, 24Vdc, 48Vdc, 110Vac, 220Vac, ID Type
1-189	ST-7588	Field Distributor, 24Vdc / 0Vdc, ID Type
1-191		Environment Specification

FnIO-A series

DeviceNet

2-5	AT2-R111	RTB, DeviceNet, Sink Input 32
2-5	AT2-R112	RTB, DeviceNet, Source Input 32
2-6	AT2-R121	RTB, DeviceNet, Sink Output 32
2-6	AT2-R122	RTB, DeviceNet, Source Output 32
2-7	AT2-R125	RTB, DeviceNet, Relay 16(4pt/1Com)
2-7	AT2-R155	RTB, DeviceNet, Relay 16(1pt/1Com)
2-8	AT2-R133	RTB, DeviceNet, Sink Input 16/Source Output 16
2-8	AT2-R134	RTB, DeviceNet, Source Input 16/Sink Output 16
2-9	AT2-R136	RTB, DeviceNet, Sink Input 16/Relay 8(4pt/1Com)
2-9	AT2-R137	RTB, DeviceNet, Source Input 16/Relay 8(4pt/1Com)
2-10	AT2-R156	RTB, DeviceNet, Sink Input 16/Relay 8(1pt/1Com)
2-10	AT2-R157	RTB, DeviceNet, Source Input 16/Relay 8(1pt/1Com)

CC-Link

2-16	AT2-R311	RTB, CC-Link, Sink Input 32
2-16	AT2-R312	RTB, CC-Link, Source Input 32
2-17	AT2-R321	RTB, CC-Link, Sink Output 32
2-17	AT2-R322	RTB, CC-Link, Source Output 32
2-18	AT2-R325	RTB, CC-Link, Relay 16(4pt/1Com)
2-18	AT2-R355	RTB, CC-Link, Relay 16(1pt/1Com)

2-19	AT2-R333	RTB, CC-Link, Sink Input 16/Source Output 16
2-19	AT2-R334	RTB, CC-Link, Source Input 16/Sink Output 16
2-20	AT2-R336	RTB, CC-Link, Sink Input 16/Relay 8(4pt/1Com)
2-20	AT2-R337	RTB, CC-Link, Source Input 16/Relay 8(4pt/1Com)
2-21	AT2-R356	CC-Link, Sink Input 16/Relay 8(1pt/1Com)
2-21	AT2-R357	CC-Link, Source Input 16/Relay 8(1pt/1Com)

PROFIBUS

2-26	AT2-R511	RTB, PROFIBUS, Sink Input 32
2-26	AT2-R512	RTB, PROFIBUS, Source Input 32
2-27	AT2-R521	RTB, PROFIBUS, Sink Output 32
2-27	AT2-R522	RTB, PROFIBUS, Source Output 32
2-28	AT2-R525	RTB, PROFIBUS, Relay 16(4pt/1Com)
2-28	AT2-R555	RTB, PROFIBUS, Relay 16(1pt/1Com)
2-29	AT2-R533	RTB, PROFIBUS, Sink Input 16/Source Output 16
2-29	AT2-R534	RTB, PROFIBUS, Source Input 16/Sink Output 16
2-30	AT2-R536	RTB, PROFIBUS, Sink Input 16/Relay 8(4pt/1Com)
2-30	AT2-R537	RTB, PROFIBUS, Source Input 16/Relay 8(4pt/1Com)
2-31	AT2-R556	RTB, PROFIBUS, Sink Input 16/Relay 8(1pt/1Com)
2-31	AT2-R557	RTB, PROFIBUS, Source Input 16/Relay 8(1pt/1Com)
2-32		Environment Specification

FnIO-C series

DeviceNet

3-4	CT-C111	32 Points Sink Input 24Vdc
3-4	CT-C112	32 Points Source Input 24Vdc
3-5	CT-C121	32 Points Sink Output 24Vdc
3-5	CT-C122	32 Points Source Output 24Vdc
3-6	CT-C133	16 Points Sink Input 24Vdc/16 Point Source Output 24Vdc
3-6	CT-C134	16 Points Source Input 24Vdc/16 Point Sink Output 24Vdc

FnIO-B series

4-1	BT-Series	DeviceNet, Board Type
4-5	ET-Series	EtherCAT, Board Type

I/O Guide Pro

5-1	I/O Guide Pro
-----	---------------

Wiring Diagram

6-1	S-Series
6-8	A-Series
6-12	C-Series

CREVIS. Co.,Ltd.

www.crevis.co.kr

경기도 용인시 기흥구 기곡로 29-4 (17099)
대표번호 : 031-899-4599
영업.마케팅 : 031-899-4501~4502, 4504
팩스번호 : 031-899-4509
E-mail : crevis@crevis.co.kr

29-4, Gigokro, Giheunggu, Yongsinsi Gyeonggido (17099)
TEL : +82-31-899-4599
Sales, Marketing : +82-31-899-4501~4502, 4504
FAX : +82-31-899-4509
E-mail : crevis@crevis.co.kr

Documentation offered by your distributor

Omni Ray AG

Im Schörli 5 | CH-8600 Dübendorf
Telefon +41 44 802 28 80
Fax +41 44 802 28 28
info@omniray.ch
www.omniray.ch
<https://shop.omniray.ch>

Omni Ray
Power of Automation

Network Oriented Technology.